

May 22nd, 2026

CONSTRUCTION WORK IN YOUR AREA

Storm Sewer Replacement and Improvement

Mississauga Road
Project 23-2300E2



Peel Region will be replacing a portion of storm sewer along Mississauga Road. Storm sewers are underground pipes that carry rainwater and melted snow from your home or business to local creeks, rivers, and Lake Ontario.

We will excavate the existing storm sewer pipe and install a new pipe to improve drainage and extend the life of the system

Construction schedule

Construction is expected to start **early June 2026** and finish by **late June 2026**. These dates may change due to weather and other unexpected events.



Contractor working hours

The work will be completed by Capital Sewer Services Inc. under contract to Peel Region. Working hours are from **9 p.m.** to **6 a.m.**, Monday to Friday. These hours are consistent with local municipal bylaws and help shorten the amount of time construction is in your area.



Traffic and parking

- It will be necessary to dig a temporary trench in the northbound left-turn lane on Mississauga Road, as shown on the map below. A detour route is provided for access to the Mississauga Road/401 Carpool Lot.



Construction safety

Construction zones require extra caution to keep everyone safe. Be aware of your surroundings when driving, walking, or biking near the construction area. Watch for construction crews and other road users, slow down, and consider other routes. Visit peelregion.ca/workzonesafety for more information.

Get the latest project updates

- Sign up for e-notices by scanning the QR code or visiting peelregion.ca/construction/signup
- Project information can be found at peelregion.ca/construction/project-23-2300-e2



We understand construction can be disruptive, and we appreciate your patience as we work to improve our community's infrastructure. This work both maintains and improves Peel's world-class water systems, allowing us to provide reliable wastewater services to support a thriving community for life.

Use our online form available at peelregion.ca/construction to submit any questions or contact us directly.

Wastewater Collection and Conveyance
Engineering Services Division
Public Works, Peel Region
Email: construction@peelregion.ca
Phone: 905-791-7800 ext. 4409

Appendix

Capital Project 23-2300E2
Proposed Detour Plan



Mississauga Road Storm Sewer Replacement at Highway 401
City of Mississauga
Ward 9 - Councillor Reid
Ward 11 - Councillor Butt

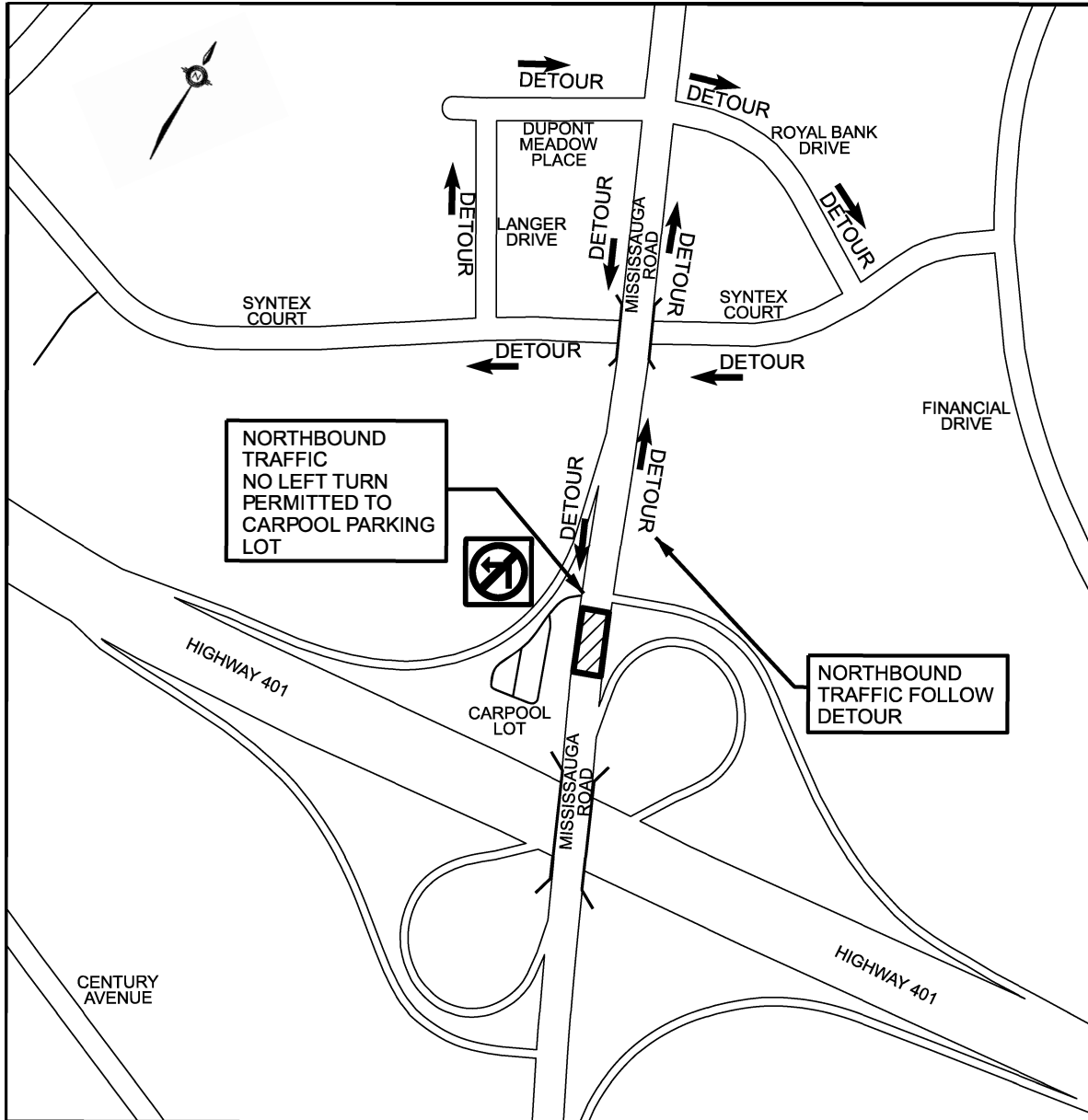

Legend:

 CONSTRUCTION ZONE

 DETOUR ROUTE